



MT60JYTG Rail Car Configuration

The MT60JYTG rail car is a multi-functional tracked transport vehicle integrating railway emergency rescue and hoisting transportation. It is equipped with a 6.5t tracked chassis at the bottom, which can adapt to various complex road conditions. The upper part is a detachable high-strength platform of 2.2m × 1.2m, with a 3t-4m crane designed on the platform. The maximum hoisting capacity is 3t, meeting the requirements of railway transportation and hoisting operations. The whole vehicle is powered by pure electricity, and a 3.6kW diesel engine is equipped as emergency power.



MT60JYTG Rail Car Configuration		
1	Overall Dimensions	
	Length (mm)	3811
	Width (mm)	1983
	Height (mm)	1925
2	Chassis	
	Tracked Chassis	6.5t Chassis Assembly
	Travel Motor	5.2Kw
	Gauge (Outer Edge)	1200-1640
3	Vehicle Power System	
	Battery Voltage/Capacity	48V/240Ah
	Motor	XQD-7.5-1
	Gear Pump	20ml/r
	High Pressure Filter	PLF-H60
	ECV55 Electro-Proportional Multi-Way Valve	ECV55_4-0005
	Control Voltage	24V
	Hydraulic Oil Tank	100L
4	Crane	
	Number of Crane Boom Sections	Three Sections
	Max. Working Range	75°
	Winch	3t
	Operation Method	Manual Pushrod + Remote Control
5	Emergency Mechanism	
	Diesel Engine	RD178-3.6Kw
	Gear Pump	4ml/r

Product Advantages

The chassis adopts a 6.5t tracked type, which can meet the complex working environment of railway sites.

With a storage width of 1.2m and a storage height of 1.93m, it can pass through tunnel access doors, meeting the trafficability requirements of railway sites.

The maximum lifting capacity of the crane is 3t, with a horizontal distance of 4m.

Pure electric power ensures long endurance, long service life, and easy maintenance.

When operating on rails, it can switch to steel wheel travel mode, reducing equipment transfer time.

The flip-up front and rear axles enable a 25% climbing capacity.

It is equipped with relevant construction operation lighting and testing equipment.

The dual-mode system of tracks and steel wheels enables it to be used on both highways and railways.

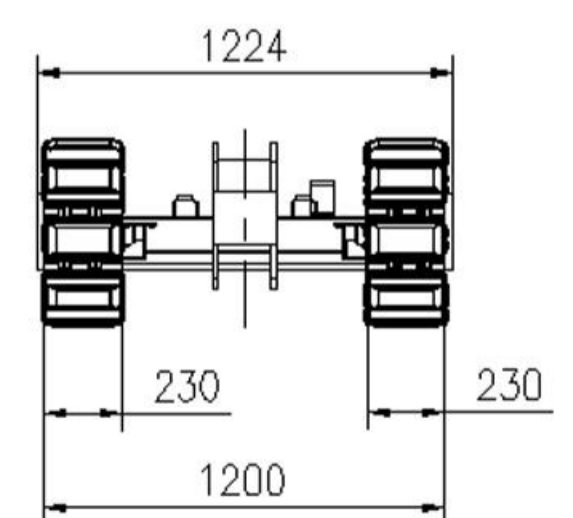
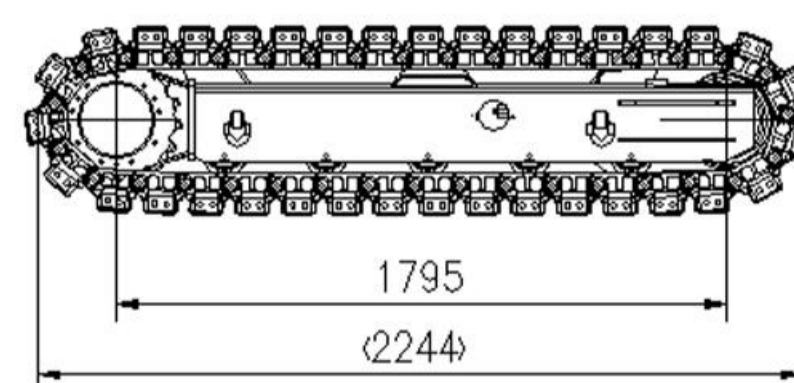
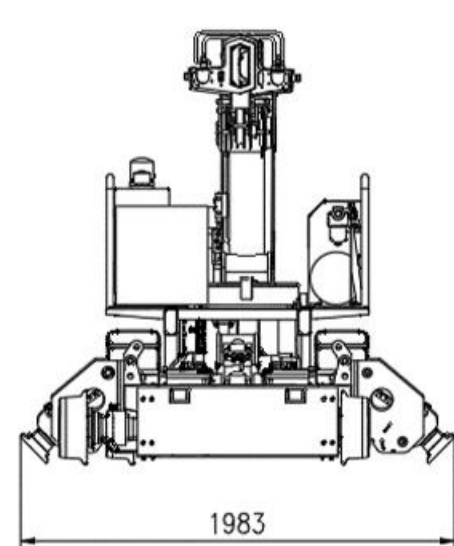
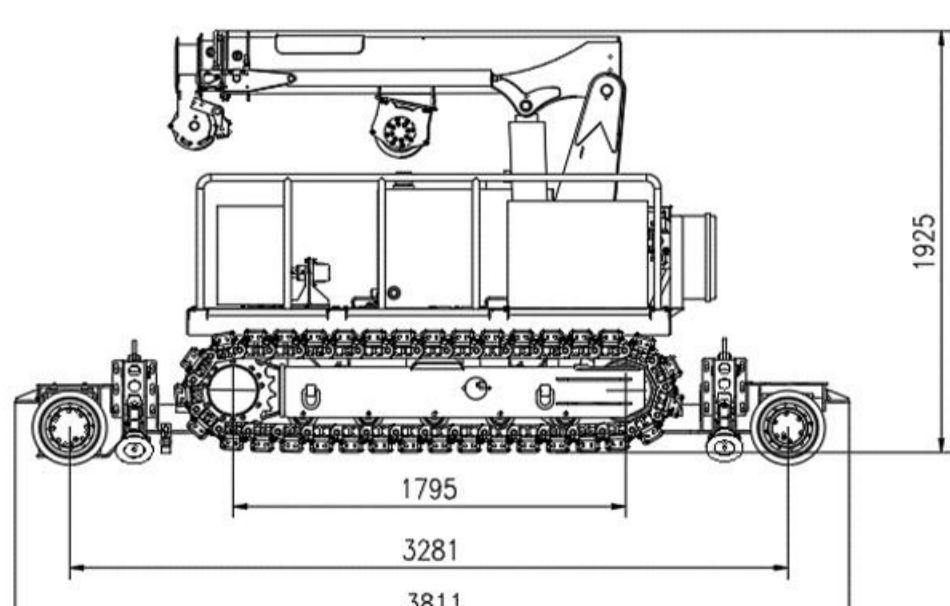

The images in this manual are for illustration only, and all copyrights belong to our company. Due to continuous technological updates, product parameters may change without prior notice.